

Rezistente electrice cartus, nelustruit, comprimate

High-duty Cartridge Heater, unground, compressed

S5110/ ... (HP 15 ...)

d (mm):	± (mm):	L (mm):	Watt / 230 V:	
10,0	0,1	100	125	160
10,0	0,1	130	200	250
10,0	0,1	160	250	315
10,0	0,1	200	300	350
12,5	0,1	100	160	200
12,5	0,1	130	220	315
12,5	0,1	160	315	400
12,5	0,1	200	400	500
12,5	0,1	250	500	600
12,5	0,1	300	600	750
16,0	0,1	100	200	280
16,0	0,1	130	280	350
16,0	0,1	160	315	400
16,0	0,1	200	450	600
16,0	0,1	250	550	700
16,0	0,1	300	700	800
20,0	0,1	100	250	350
20,0	0,1	130	350	400
20,0	0,1	160	400	500
20,0	0,1	200	630	700
20,0	0,1	250	700	800
20,0	0,1	300	1000	1250

Rezistente electrice cartus, nelustruit, necomprimate

Cartridge Heater, unground, non compressed

S5115/ ... (HP 16 ...)

d (mm)	± (mm)	Material:			Diagrama de valoare aproximativa a puterii, putere mica la 230V Approximate value chart for power, low watt at 230V												
		St	Ms	CN	L (mm):	65	80	100	125	160	200	250	320	400	500	630	800
9,45	± 0,10	☐	☐	■	65	80	100	125	160	200	250	320	400	500	630	800	
10,00		■	■	■													
11,00		■	■	■													
11,30		☐	■	☐													
12,00	± 0,10	■	■	■	80	100	125	160	200	250	320	400	500	630	800	1000	
12,50		☐	■	■													
12,57		☐	☐	■													
12,70		■	■	■													
14,00	± 0,10	■	■	☐	110	140	180	220	280	350	450	550	700	850	1100	1400	
15,00		■	■	■													
15,80		■	■	☐													
16,00		■	■	■													
16,50	± 0,10	■	■	☐	125	160	200	250	320	400	500	630	800	1000	1250	1600	
17,00		■	■	☐													
17,50		■	■	☐													
18,00		■	■	■													
19,00	± 0,15	■	☐	☐	160	200	250	320	400	500	630	800	1000	1250	1600	2000	
19,50		■	■	☐													
20,00		■	■	■													
21,00		■	☐	☐													
23,00	± 0,15	■	■	☐	200	250	320	400	500	630	800	1000	1250	1600	2000	2500	
24,00		■	■	■													
25,00		■	☐	☐													
31,50	± 0,15	■	☐	☐	250	320	400	500	630	800	1000	1250	1600	2000	2500	3200	
32,00		■	■	■													
40,00	± 0,20	■	■	■	320	400	500	630	800	1000	1250	1600	2000	2500	3200	4000	

Rezistente electrice
cartus

High-duty
Cartridge Heaters

S5101/ ... (HP 10)

S5105/ ... (HP 12)

S5110/ ... (HP 15)

S5115/ ... (HP 16)

Tipuri de montare
Mounting variations

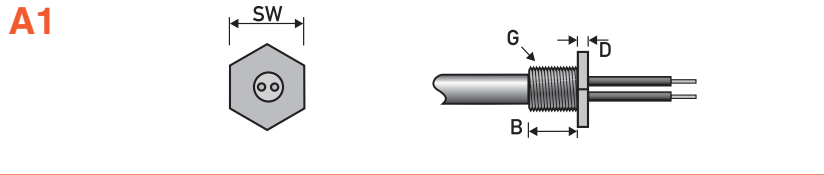

ø	6,5	8	10	12,5	16	20	1/4"	3/8"	1/2"	5/8"
B	10	10	12	12	12	14	10	12	12	12
D	4	4	4	4	4	4	4	4	4	4
SW	12	14	17	19	24	30	12	17	19	24
G	M10x1	M12x1	M14x1,5	M16x1,5	M20x1,5	M26x1,5	R1/8"	R1/4"	R3/8"	R1/2"

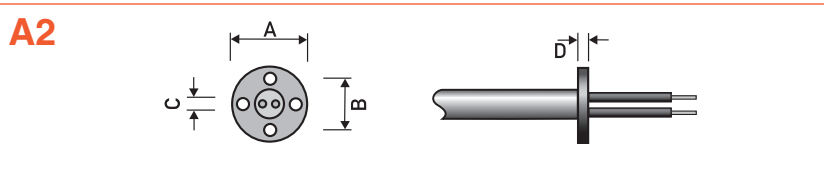

ø	6,5	8	10	12,5	16	20	1/4"	3/8"	1/2"	5/8"
A	18	18	27	27	43	43	18	27	27	43
B	13	13	20	20	32	32	13	20	20	32
C	2,2	2,2	3,2	3,2	5,5	5,5	2,2	3,2	3,2	5,5
D	1	1	1,5	1,5	2	2	1	1,5	1,5	2

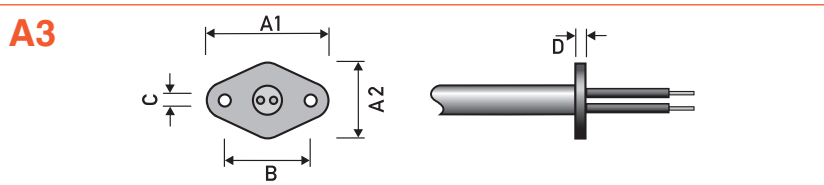

ø	6,5	8	10	12,5	16	20	1/4"	3/8"	1/2"	5/8"
A1	-	-	-	-	60	60	-	-	-	60
A2	-	-	-	-	30	30	-	-	-	30
B	-	-	-	-	45	45	-	-	-	45
C	-	-	-	-	5,5	5,5	-	-	-	5,5
D	-	-	-	-	2,5	2,5	-	-	-	2,5

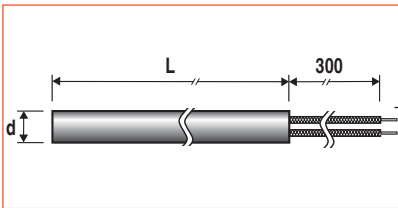

Rezistente electrice
cartusHigh-duty
Cartridge HeatersTipuri de conductoare
Lead variationsTipuri de iesiri a conductoarelor
Lead outlet variations

B1

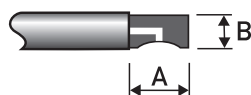

ø	6,5	8	10	12,5	16
A	12,5	14,5	18	19,5	22,05
B	6	7,5	9,5	12	15,5

ø	20	1/4"	3/8"	1/2"	5/8"
A	25	12,5	18	19,5	22,5
B	19,5	6	9	12	15,5

B2

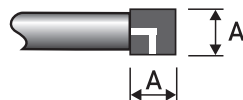

ø	6,5	8	10	12,5	16
A	10	10	15	15	20

ø	20	1/4"	3/8"	1/2"	5/8"
A	25	10	15	15	20

B3

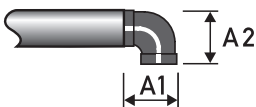

ø	6,5	8	10	12,5	16
A1 ≤	15	18	23	25	23
A1 ≥	10	15	17	20	23
A2	13	16	19	22	23

ø	20	1/4"	3/8"	1/2"	5/8"
A1 ≤	28	15	23	25	23
A1 ≥	28	10	17	20	23
A2	33	13	19	22	23

C1

Conductoare cu izolare de
Teflon, max. 230° CTeflon-insulated wire leads, max.
230 °C

C2

Conductoare de cupru flexibile cu izolare
siliconica flexibila. Sigilare speciala
Max. 180°CHigh flexible silicone-insulated
copper wire leads. Specially sealed.
Max. 180°C

C3

Cablul cu izolare siliconica sau
neopren cu 3 conductoareSilicon or neopren insulated
wire leads with 3 cores

C4

Conductoare rigide de nichelina
cu legatura flexibilaRigid nickel wires with crimped
flexible cords

C5

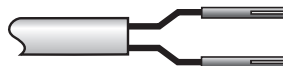
Pinuri de alama sudate la con-
ductoare de nichelinaPins (brass), soldered at nickel
wires

C6

Izolatie de fibra de sticla
pentru ecranarea suplimentara a
conductoarelorFiberglass sleeve for additionally
shielding of both leads

C7

Manson de fibra de sticla
pentru intreaga suprafata a
conductoarelorFiberglass-sleeve covering the
entire surface covering each
individual lead

C8

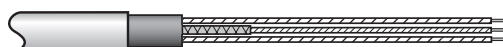
Conductor de impantare
aditionala fixat la teaca de cartusAdditional earthing cable, fixed
to cartridge casing

C9

Inele ceramice aditionale
pentru temperaturi de pana la max. 280 ... CAdditional ceramic beads for
temperatures max. 280 ... C

C10

Protectie flexibila aditionala
contra abraziunii, cu invelis
armat din otelAdditional flexible abrasion pro-
tection, steel armored cover

C11

Protectie flexibila aditionala
contra abraziunii, cu manson cu
impletitura metalicaAdditional flexible abrasion
protection, with metal braided
sleeving

**Rezistente electrice
cartus**
LA CEREREA CLIENTULUI
**High-duty
Cartridge Heaters**
CUSTOM MADE

Formular comanda		Order form
Firma/Company _____		
Persoana contact/Contact _____		
Tel.: _____	Fax: _____	Data/Date: _____
<input type="checkbox"/> Comanda/Order	Nr./No.: _____	<input type="checkbox"/> Cerere oferta/Quotation

Specificatii comanda:

- n:** Cantitatea
Nr.: S5101 = lustruit f7, metric
 S5105 = lustruit f7, toli
 S5110 = nelustruit, comprimate, metric
 S5115 = nelustruit, necomprimate, metric
- d:** Diametru, metric (4 - 25 mm)
 Diametru, toli (1/8" - 1")
- L:** Lungime rezistenta electrica cartus (pana la 3000 mm)
P: Puterea (65 - 4000 Watt)
A: Tipuri de montare (4.08 A1 - 3)
B: Tipuri de iesiri a conductoarelor (4.09 B1 - 3)
C: Tipuri de conductoare (4.09 C1 - 11)
M: Material (numai pentru S5115)
 St = Tub otel
 Ms = Tub alama
 CN = Tub otel inoxidabil
- I2:** Lungimea conductoarelor
U: 230 V
 400 V
T: 1 = cu termocuplu
 (cu exceptia S5115)
 2 = fara termocuplu

Order specifications:

- n:** Quantity
Nr.: S5101 = ground f7, metric
 S5105 = ground f7, Inch
 S5110 = unground, compressed, metric
 S5115 = unground, non compressed, metric
- d:** Diameter, metric (4 - 25 mm)
 Diameter, Inch (1/8" - 1")
- L:** Length cartridge heater (up to 3000 mm)
P: Power (65 - 4000 Watt)
A: Mounting variations (4.08 A1 - 3)
B: Lead outlet variations (4.09 B1 - 3)
C: Lead variations (4.09 C1 - 11)
M: Material (for S5115 only)
 St = Tubular steel
 Ms = Brass tubular
 CN = High grade steel tubular
- I2:** Length connection lead
U: 230 V
 400 V
T: 1 = with thermocouple
 (except S5115)
 2 = without thermocouple

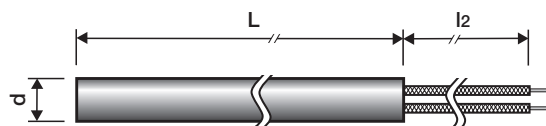

n	Nr. / No.	d [mm]	L [mm]	P [Watt]	A	B	C	M	I2 [mm]	U [Volt]	T
	/	X	X	X	X	X	X	X	X	X	X
	/	X	X	X	X	X	X	X	X	X	X
	/	X	X	X	X	X	X	X	X	X	X
	/	X	X	X	X	X	X	X	X	X	X
	/	X	X	X	X	X	X	X	X	X	X